

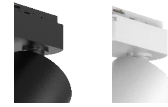

LUXPOINT® GU10 Spot Light Datasheet



Colors:



Black White



Our GU10 spotlight series includes 3 easy-to-install options: surface-mounted version and 2-wire / 3-Phase Track version. Both are perfect for homes or businesses, offering flexible lighting solutions. they use a GU10 fitting for various bulb types, ensuring you can adjust brightness and save energy.

Benefits

- Versatile Lighting Options
- Enhanced Ambiance
- Customizable Configurations
- Long-lasting Durability
- Adjustable Angle

Applications

- Homes
- Receptions
- Galleries
- Retail stores
- Restaurants
- Other demanding environments

LUXPOINT® GU10 Spot Light

Technical Data



1. 2-Wire Track



2. 3-Phase Track



3. Surface mounted

Electrical and Mechanical Specifications

	1. 2-Wire Track	2. 3-Phase Track	2. Surface mounted
Input Voltage	220-240V~ 50/60Hz		
Lampshade size	Height	89mm	
	Diameter	Ø 57mm	
Dimensions	Height	142mm	131mm
	Width	83mm	77mm
Weight	165g	210g	210g
Housing	Aluminum		

System Specifications

Power	AC mains
Control	ON / OFF
Installation	Surface mounted / 2-Wire Track / 3-Phase Track
Environment	Indoor (IP20)
Safety Approval	CE, UKCA, RoHS, Electrical Protection Class I (Surface mounted), Class II (Track mounted)

Due to the special conditions of manufacturing process of LED, the typical data of technical parameters can only reflect statistical figures and do not necessarily correspond to the actual parameters of each single product which could differ from typical data.

Exceeding maximum ratings for operation voltage will cause hazardous overload and will likely destroy the LED module.

Exceeding maximum ratings for operation and storage temperature will reduce expected life time or destroy the LED module.

Specifications are subject to change without notice. Errors and omission excepted, always make sure to use the most recent release.

LUXPOINT® GU10 Spot Light

Dimension (Unit: mm)

2-Wire Track

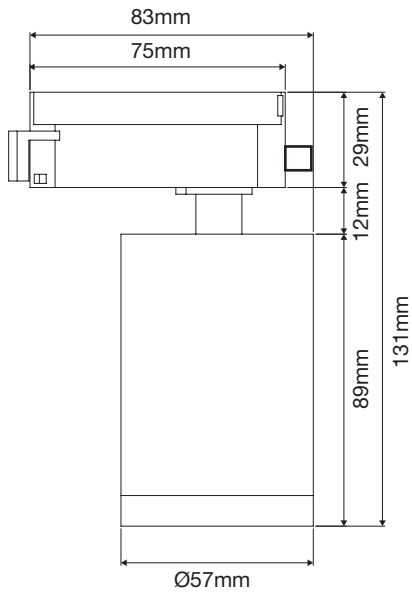

3-Phase Track

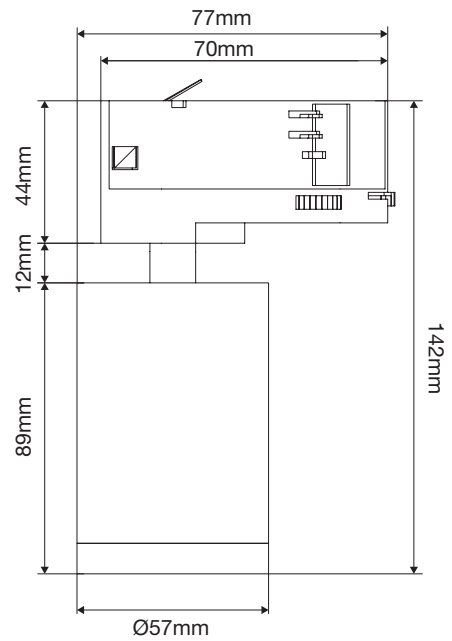

Surface mounted

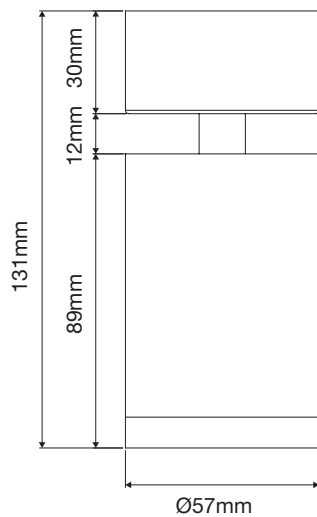

LUXPOINT® GU10 Spot Light

Ordering codes

Fixture

Short Text	Type	Installation	Lamp base	Color	Item code	EAN-13
LP SP 001 TRK GU10 2W WH	Single	2-Wire Track	GU10	White	TXGL25100081455	4895271101633
LP SP 001 TRK GU10 2W BL	Single	2-Wire Track	GU10	Black	TXGL25100081555	4895271101640
LP SP 001 TRK GU10 4W WH	Single	3-Phase Track	GU10	White	TXGL26100119355	4895271102173
LP SP 001 TRK GU10 4W BL	Single	3-Phase Track	GU10	Black	TXGL26100119455	4895271102180
LP SP 001 ADJ GU10 SF WH	Single	Surface mounted	GU10	White	TXGL25100081655	4895271101657
LP SP 001 ADJ GU10 SF BL	Single	Surface mounted	GU10	Black	TXGL25100081755	4895271101664

Service contact:
Traxon Technologies Ltd.
Room 1604, 16/F, First Group Centre, 23 Wang Chiu Road,
Kowloon Bay, Kowloon, Hong Kong, China
www.traxon-ecue.com

Traxon Technologies Europe GmbH
Im Dörener Feld 8, 33100 Paderborn, Germany