

# Butler XT3

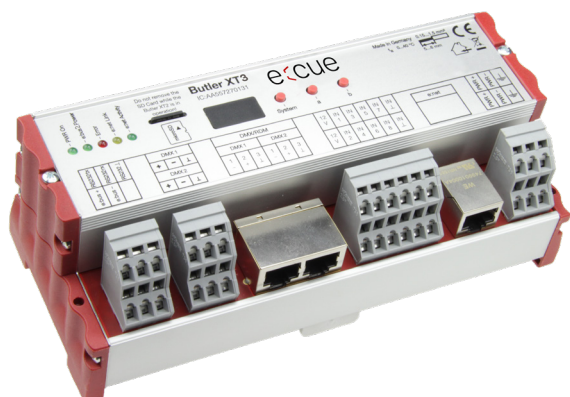

## Butler XT3

The Butler XT3 is a DMX/RDM engine which can be used in standalone mode to replay and loop lighting shows which have been previously uploaded and programmed using a PC running the e:cue LAS software suite. It can also be used as a DMX/RDM device, controlled by another e:cue engine. In standalone mode, the Butler XT3 can control up to 1,024 DMX/RDM channels. It is possible to increase the DMX/RDM channel count to 65,536 channels by clustering more Butler XT3s. The engine offers a variety of connectivity options for controlling the lighting show running on the device. These include direct connection to the Glass Touch GT12X, RS-232, digital inputs and Ethernet.

## Main features

- Controls up to 1,024 DMX/RDM channels
- Remote control via Glass Touch GT12X User Terminals (up to 8), using the e:bus2 protocol → not e:bus compatible (old Glass Touch series and Butler XT2)!
- Supports RDM protocol for bidirectional communication
- Internal real-time and astronomical clock
- Standalone configuration via web browser
- Control in standalone mode with ActionPad applications for desktop or iOS and Android
- Serial input port (RS-232) for connectivity to 3rd party systems
- Eight freely configurable (optically isolated) digital inputs
- MicroSD card for show upload/configuration file storage (included in delivery)
- Freely configurable actions for standalone mode (e.g. play, pause, resume, stop, previous and next cue list, intensity up/down), plays up to eight cuelist in parallel

## Butler XT3 - Powerful Control. Seamless Performance.

The e:cue Butler XT3 redefines intelligent lighting control with unmatched flexibility and reliability. Designed for dynamic architectural and interactive installations, the Butler XT3 delivers high-performance lighting playback in a compact, standalone unit. Whether you're illuminating a boutique space or a large-scale façade, it offers intuitive scheduling, seamless integration, and real-time control—all without the need for a central server.

- Master intensity dimmable
- Cue list download from e:cue Lighting Application Suite

## Delivery scope

- Butler XT3
- MicroSD card
- Welcome note, Safety instructions

## Item code

CL24100004935  
AA6137401HA

## Optional accessories

- Accessory pack (including power supply, network cable, RS-232 to open wire adaptor, CAT5e cross cable 1m, e:cue software CD) AA556690035
- Glass Touch GT12X White - Custom labeling CL25100005435
- Glass Touch GT12X White - Fixed Number Layout CL25100008135
- Glass Touch GT12X Black - Custom labeling tba
- Glass Touch GT12X Black - Fixed Number Layout tba
- Glass Touch GT12X - Custom Print CL25200008035

## Product specifications

Dimensions (W x H x D)	177 x 60 x 75 mm / 7 x 2.4 x 3 inch
Weight	0.4 kg / 0.88 lbs
Power supply input	12 ... 24 V DC with e:bus2 24 V DC only 170 mA @ 24 V @ 8 x Glass Touch
Op. / storage temperature	0 ... 40 °C / 32 ... 104 °F
Op. / storage humidity	0 ... 80% RH, non-condensing
Protection class	IP20
Housing	Aluminium, Polyamide 6.6
Mounting	on 35 mm DIN rail
Certificates	CE, UKCA

## Interface specifications

Inputs	1 x RS-232 (clamp terminals) 8 x optically isolated digital input max voltage 24 V DC 12 V DC x 15 mA power supply for external contacts
Outputs	2 x DMX / RDM (RJ45, clamp terminals)
System link	1 x e:bus2 (clamp terminals; not e:bus compatible!) max 16 V DC x 115 mA 1 x e:net (RJ45)
Display	7-segment LED
User interfaces	3 Buttons 5 LEDs

## Dimensions (mm/in)

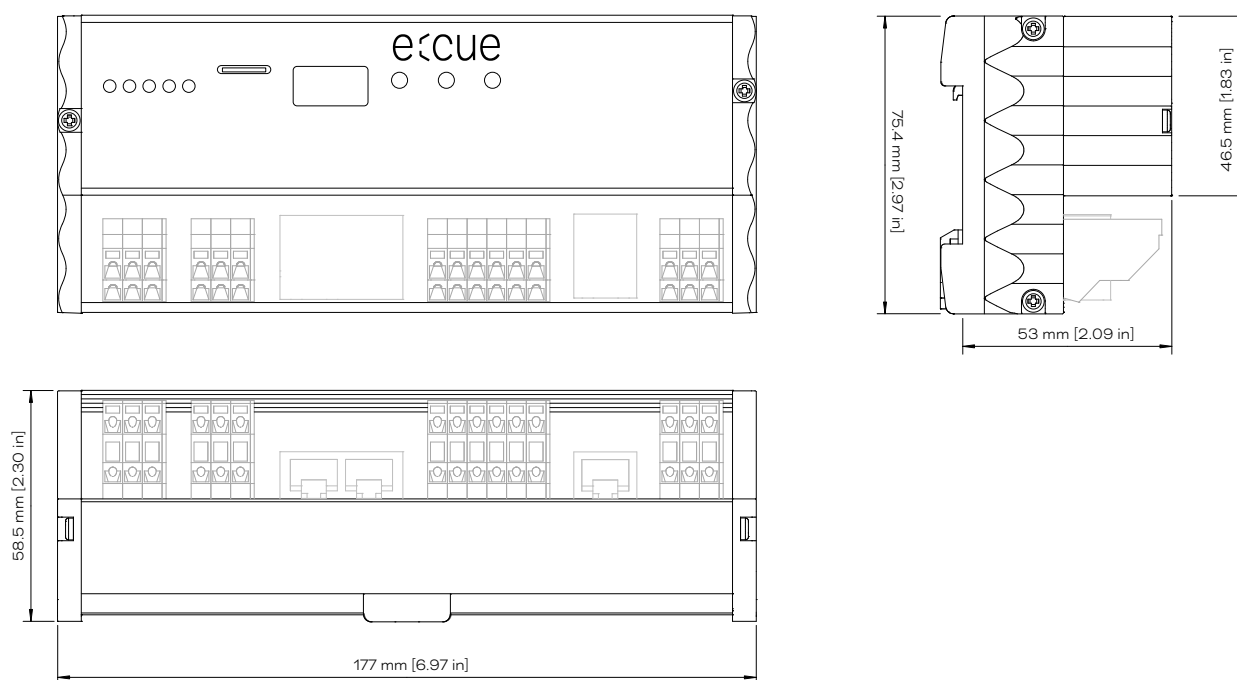

## Connection diagram

Example (Standalone or Online Mode):

