

LEDENVO® Streetlight Plus

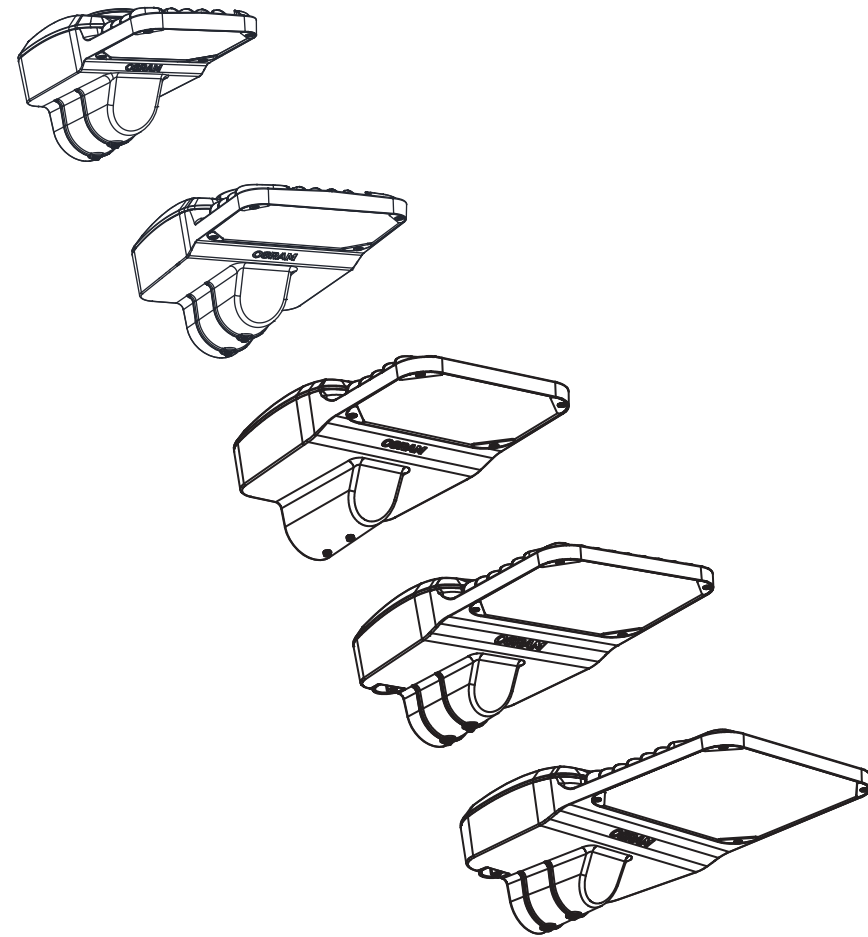

LEDENVO® Streetlight Plus

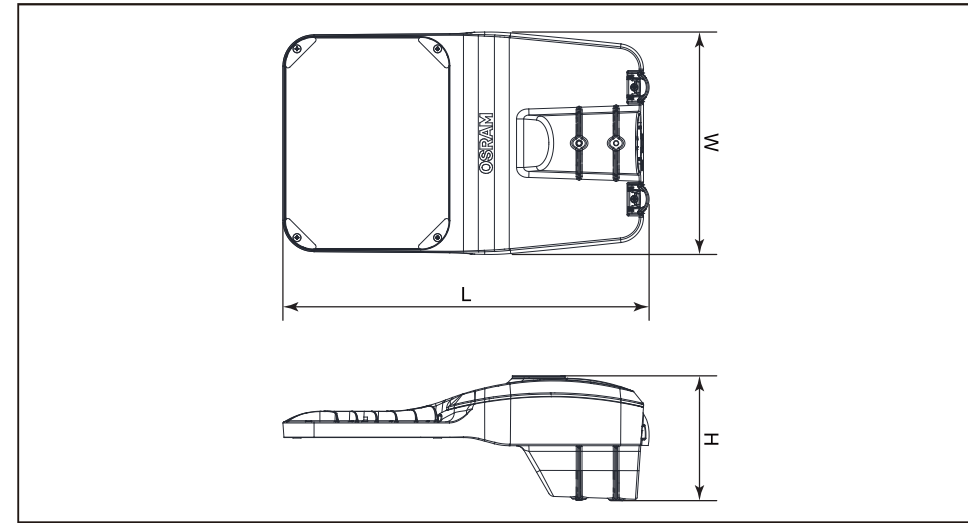

Model	W (mm)	L (mm)	H (mm)	Wattage (W)	Voltage (V)	Installation height (m)	Weight (kg)	Maximum projected area (m ²)		IP	ta
								Front	Side		
LEDENVO ST Plus 12-30W LC	167	306	142	12-30W	220-240 VAC 50/60 Hz	6-9	1.58	0.051	0.025	66	50°C
LEDENVO ST Plus 35-60W LC	218	325	143	35-60W			2.61	0.071	0.026		
LEDENVO ST Plus 65-90W LC	245	379	146	65-90W			3.37	0.089	0.030		
LEDENVO ST Plus 95-120W LC	271	446	146	95-120W			4.03	0.114	0.032		
LEDENVO ST Plus 130-180W LC	299	496	148	130-180W		4.80	0.140	0.033			
LEDENVO ST Plus 12-30W GC	167	306	142	12-30W		6-9	1.80	0.051	0.025		
LEDENVO ST Plus 35-60W GC	218	325	143	35-60W			2.90	0.071	0.026		
LEDENVO ST Plus 65-90W GC	245	379	146	65-90W			3.78	0.089	0.030		
LEDENVO ST Plus 95-120W GC	271	446	146	95-120W			4.62	0.114	0.032		
LEDENVO ST Plus 130-180W GC	299	496	148	130-180W		8-11	5.62	0.140	0.033		

LEDENVO® Streetlight Plus

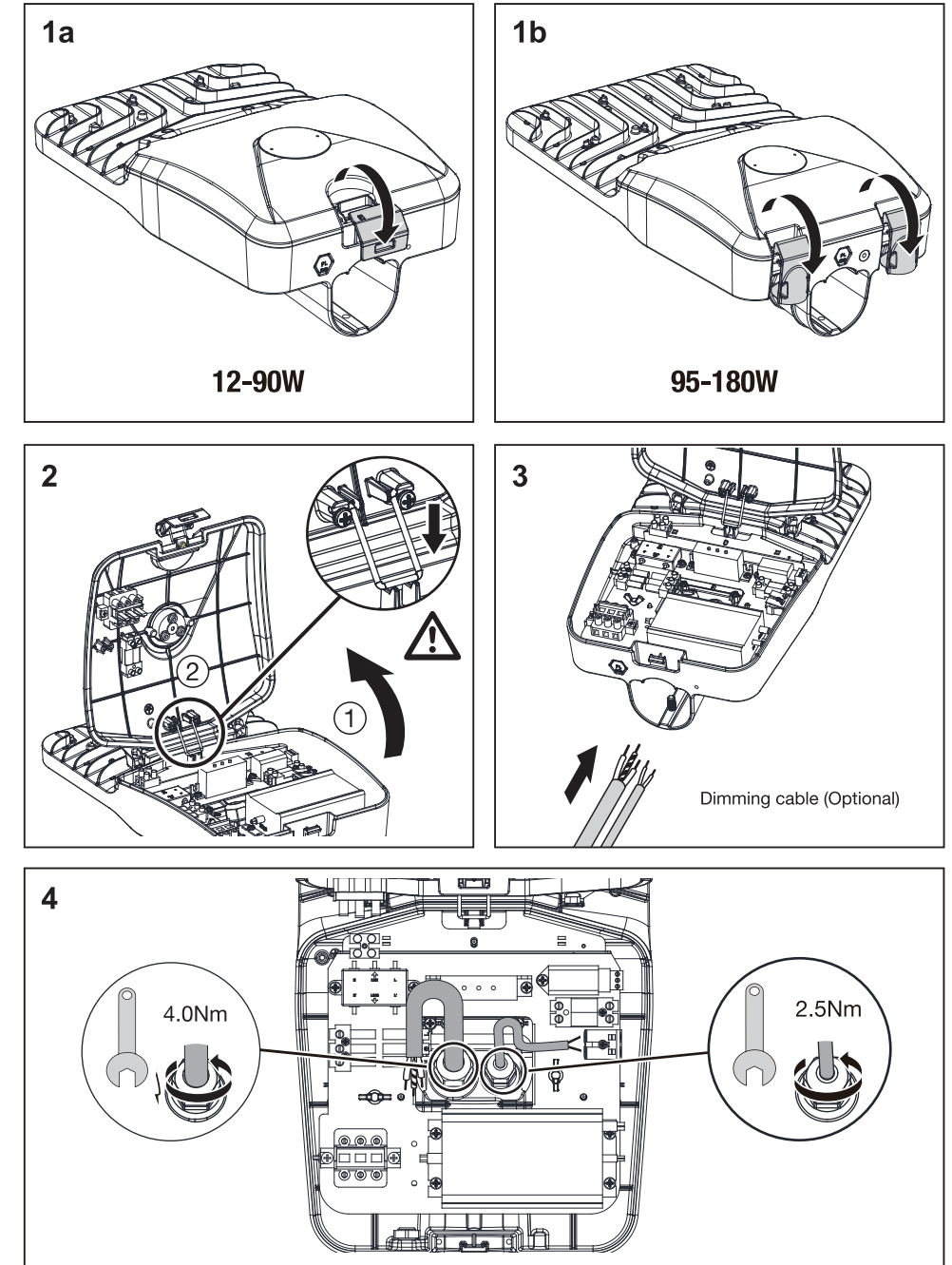

- Please read instruction carefully before assembling and installation
- Please keep instruction as reference in the future

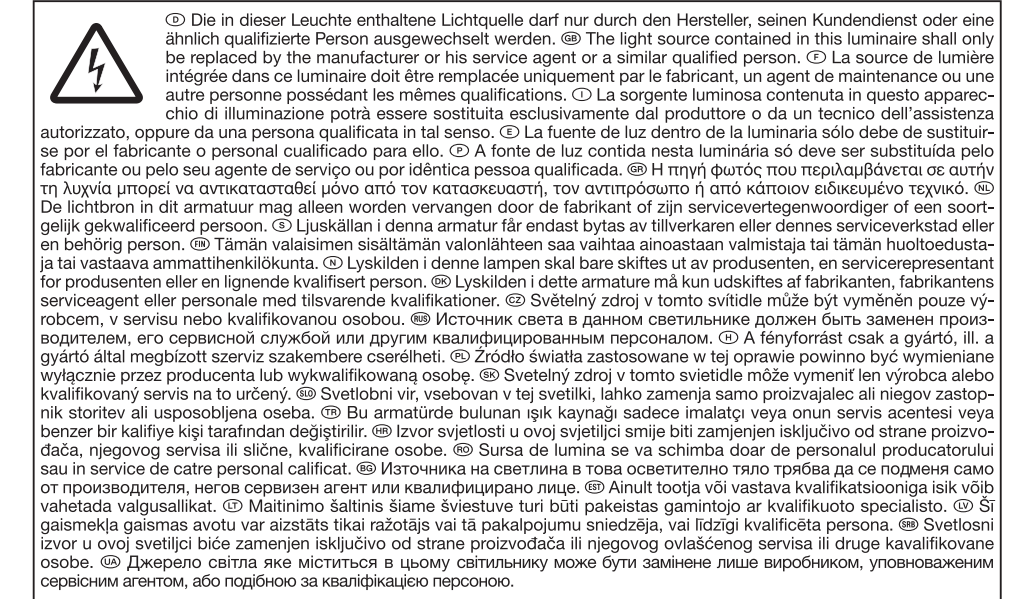
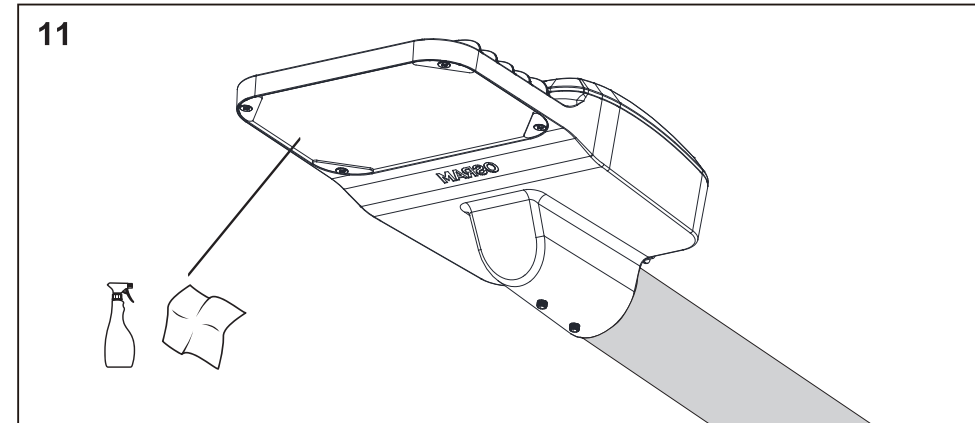
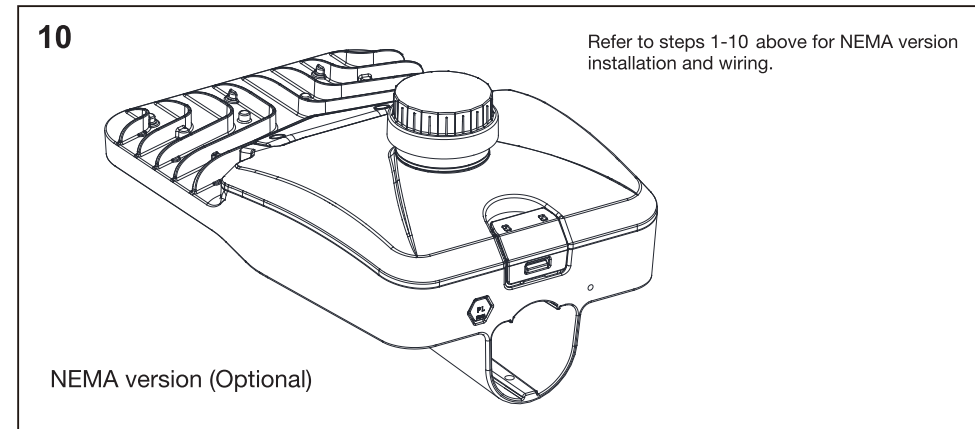
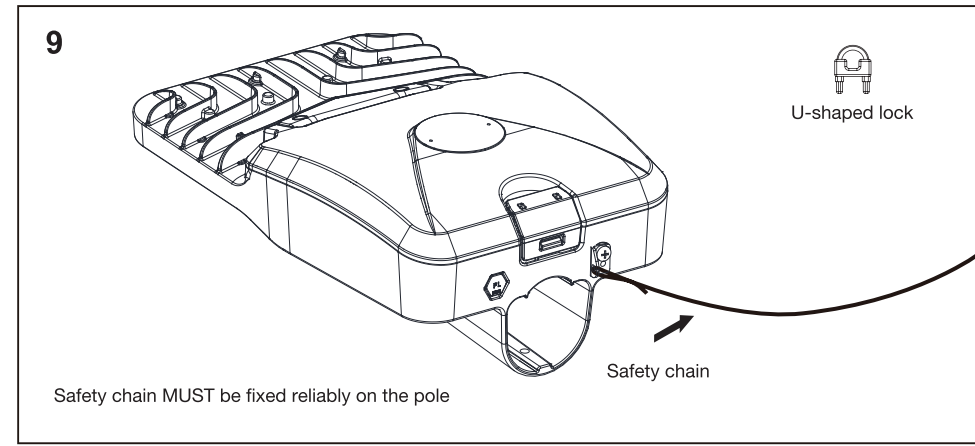
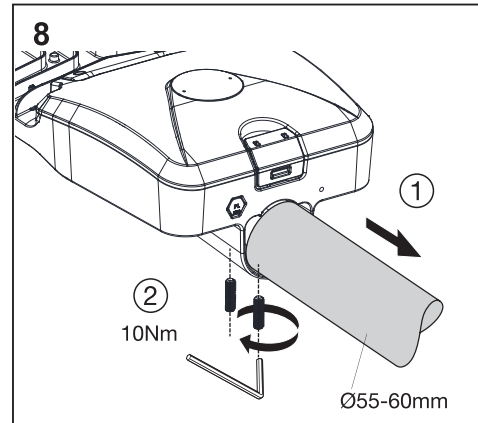
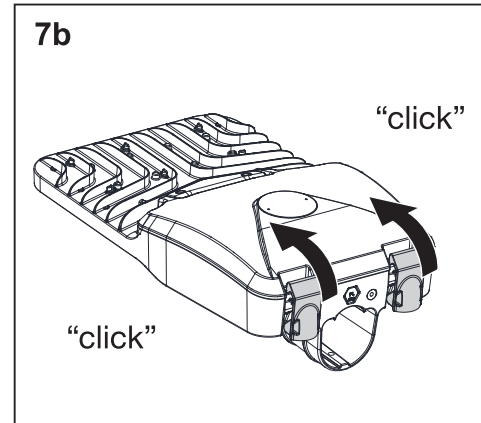
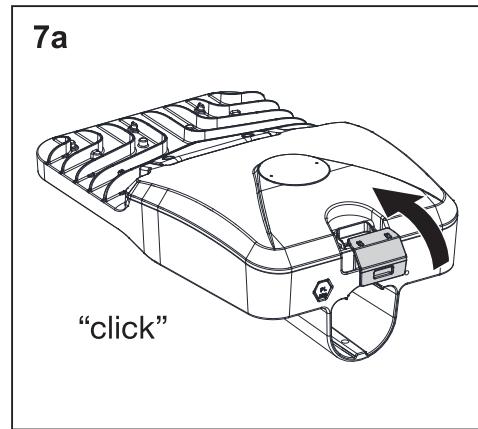
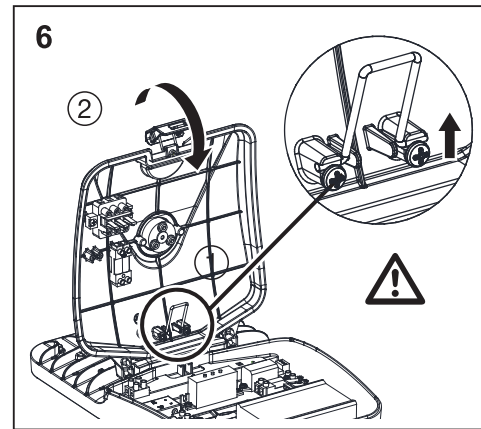
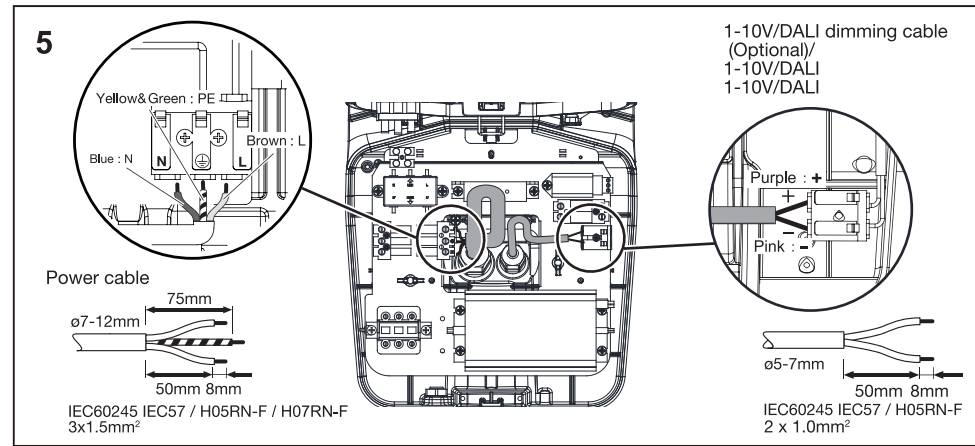

WARNING :

1. Ensure that any installation and maintenance be performed by a qualified electrician and the luminaire is wired in accordance with the latest IEE electrical regulations or the local equipments.
2. Ensure that the power supply is off before starting installation and maintenance. Do not switch on until the installation or maintenance is completed.
3. The light source of this luminaire is a non-user alternative light source, the light source contained in this luminaire shall only be replaced by the manufacturer of his service agent or a similar qualified person.
4. Make sure the products are grounded.
5. Power supply system should be equipped with SPD (Surge protection Device) accordance with electrical regulations.
6. The products are suitable for indoor and outdoor use.
7. At least basic insulation between LV supply and controlling terminal was provided.
8. Controlling terminal can be connected with FELV and SELV control system.
9. For NEMA version, Make sure to meet the waterproof requirement after installing the short cap or NEMA controller.
10. Terminal block not included, installation must be performed by a qualified person.
11. Glass cover protection by the use of high impact resistant glass.

OSRAM is a trademark of OSRAM GmbH.
Traxon is the exclusive licensee of product trademark OSRAM for Professional General Lighting products in Mainland China, Hong Kong and Macau, additional fixed list of General Lighting products.

Traxon Technologies Ltd.
Room 113, wireless centre, 3 Science Park East Avenue, Shatin, Hong Kong

Traxon Technologies Europe GmbH
Karl-Schurz-Str. 38, 33100 Paderborn, Germany

Traxon Lighting Company Limited
B402 - B421, Building 6, Northwest Shenjui Science and Technology Pioneer Park, the intersection of Taohua Road and Binglang Road, Fubao Community, Fubao Street, Futian District, Shenzhen

