

DALI-2 Panel 4-Key

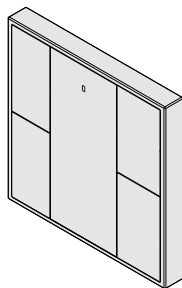

Highlights

- DALI-2 control device with 4 push buttons according to IEC62386-101, IEC62386-103, IEC62386-301 and IEC62386-332
- Available in three color versions: metal, black and white
- Suitable for integration and in combination with DALI-2 compliant central control units
- Supports feedback functionality, provides 8 LEDs
- Multimaster capable, multiple modules can be installed on the DALI line
- DALI bus powered, no extra power supply required
- Easy installation: the device can be installed in a flush-mounted installation box

Delivery scope

Identcode

- e:cue DALI-2 Panel 4-Key (main body, frame, mounting plate)
 - metal CL23100279055
 - white CL23100279255
 - black CL23100279455
- Screws, 2 x
- Transparent central cover plate
- Safety instructions
- Instructions

Optional accessories

- SYMPL dali Node AB444230035

Product specifications

Dimensions (W x H x D)	80 x 80 x 26.6 mm / 3.15 x 3.15 x 1.05 in
Weight	black, white: 89.5 g / 0.2 lb metal: 101.4 g / 0.22 lb
Mounting	Wall mount, suitable for most international in-wall mounted boxes
Max. casing temperature T _c	75 °C
Protection class	II in Intended Use

e:cue Interfaces

Lighting applications are heterogeneous by nature. e:cue interfaces serve to integrate many networks, protocols and third party products into e:cue solutions. They also aid in applying special control functions for fixtures, they integrate analog or mechanical signaling into the digital world and offer bridging functions. e:cue interfaces are the links to bring together the many techniques and technologies of lighting control.

Protection degree housing	IP20
Protection degree terminals	IP20
Certificates	CE, DALI-2, UKCA, RoHS

DALI interface

Input type	DALI
Marking	DA, DA
Voltage range	12 V DC - 22.5 V DC (according IEC62386-101)
Typ. current consumption DALI (at 16.5 V)	2 mA
Max. current consumption DALI (Inrush current at 22.5 V)	10 mA
Number of addresses for DALI control gear	DALI
Number of addresses for DALI control devices	4 programmable push buttons
Number of feedback LEDs	8 programmable LEDs
Push confirmation LED	yes (1)

Terminals

Connection type	Push-In
Wire size solid core	0.2 ... 1.5 mm ² (AWG 26 ... AWG 16)
Wire size fine core	0.2 ... 1.5 mm ² (AWG 26 ... AWG 16)
Wire size using wire end ferrule	0.25 ... 1.0 mm ²
Stripping length	9 ... 10 mm / 0.35 ... 0.39 inch
Tightening / release of wire	Push button

Environment conditions

Storing temperature	-20 ... +50 °C / -4 ... 122 °F
Working ambient temperature	-20 ... +50 °C / -4 ... 122 °F
Relative humidity	8 ... 80 %



DALI-2 Panel 4-Key

Dimensions

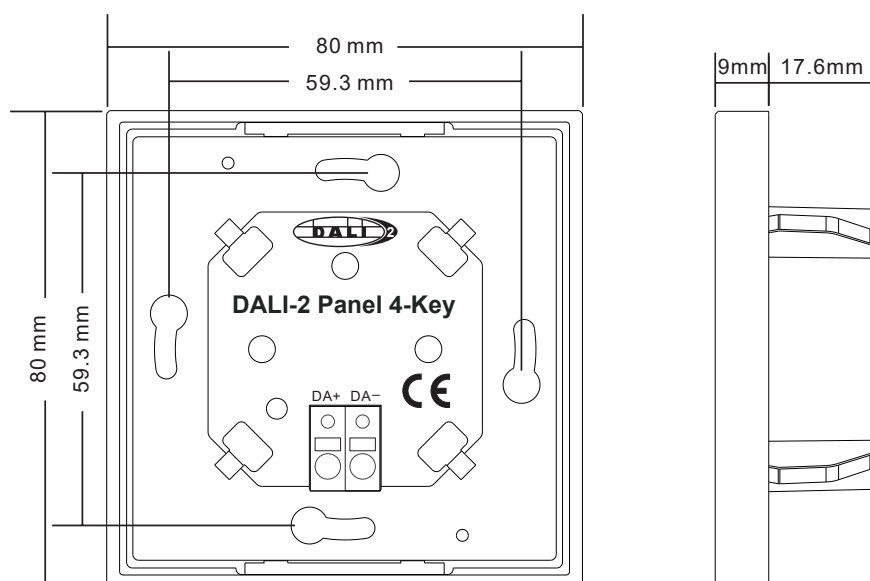

Application

Integration in a system with DALI-2 compliant central control unit, button pushes result in input notifications (event messages).

System diagram

A) e.net (ethernet based protocol)

B) DALI

