

Glass Touch GT12X

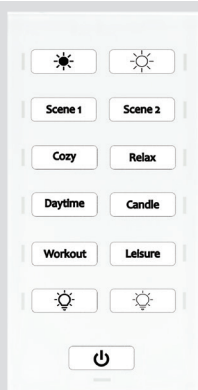

Glass Touch GT12X – Elegant and versatile control

The Glass Touch GT12X is a user terminal featuring a modern design with a glass surface and touch-sensitive keys for intuitive operation. It supports both the DALI-2 protocol and the Butler XT3 via the e:bus2 protocol.

Using e:cue software, the keys can be customized to meet specific project requirements. Suitable for a variety of high-end lighting applications—including hotel rooms, offices, conference spaces, residential settings, and cruise ships—the Glass Touch GT12X combines functionality with a clean aesthetic.

The device is wall-mountable and supports the connection of up to 8 units via e:bus2, using flexible wiring topologies such as daisy chain or star.

Key Features of the Glass Touch GT12X

- 13 Touch-Sensitive Sensor Keys
- Each with status LEDs and LED button feedback for clear, responsive interaction.
- Flexible Glass Design Options
- Choose from five elegant variants:
 - White or black glass with empty key areas for custom labeling
 - White or black glass with numbered keys
 - Fully custom-printed glass for a unique, tailored look
- Custom Labeling Made Easy
- Design your own text and symbols
- Insert printed labels into the device via an integrated tray
- Certified and Compatible
- DALI-2 certified for industry-standard control

- Also supports e:bus2 protocol (not compatible with older e:bus)
- Effortless Installation
- Fits standard in-wall electrical boxes
- Powered via DALI-2 or e:bus2—no separate power source needed
- Topology-free cabling with simple 2-wire power/data connection
- Connect up to 8 devices in a daisy chain via e:bus2
- Lock/unlock with a key combination to clean the device

Delivery scope

Identcode

- Glass Touch GT12X White - Custom labeling
CL25100005435
- Glass Touch GT12X Black - Custom labeling
tba
- Glass Touch GT12X White - Fixed Number Layout
CL25100008135
- Glass Touch GT12X Black - Fixed Number Layout
tba
- Glass Touch GT12X - Custom Print
CL25200008035
- Mounting plate
- Allen Key
- Default paper insert (only CL25100005435)
- Safety instructions
- Welcome note

Optional accessories

- Butler XT3
CL24100004935
- SYMPL Fusion
CL24100603935
- with SYMPL Fusion DALI-2 Module 1Ch.
CL24100604035
- SYMPL dali Node
AB444230035

Product specifications

Dimensions (W x H x D)	80 x 160 x 13 mm / - estimation - 3.15 x 6.3 x 0.51 in
Weight	200 g (incl. mounting plate)
Power supply	via DALI-2 bus or e:bus2 (2-wire cabling)
Power consumption	0.15 W
Operating temperature	0 ... 45 °C / 32 ... 113 °F
Storage temperature	-20 ... 75 °C / -4 ... 167 °F
Op. / Stor. humidity	0 ... 80% RH, non-condensing
Ingress protection	IP40
Housing	Glass (surface) Aluminium (mounting plate) tba (housing body) UV, scratch and cleaning detergent resistant
Mounting	In standard in-wall fitting
Certificates	CE, UKCA, DALI-2, ETL pending

Interface specifications

Protocols	DALI-2 e:bus2 (not e:bus compatible!)
User interfaces	13 x capacitive touch sensor 13 x feedback LED (monochrome red, protocol controlled) Rotary DIP switch (protocol selection, e:bus2 addressing)
Beeper	Acoustic feedback

Glass Touch Designer

Create your custom label (power button excluded, CL25100005435) or fully custom-printed glass (CL25200008035).

Use the Glass Touch Designer, available on the e:cue website, to easily design your personalized paper insert or complete glass print. For the paper insert, simply print it using a standard printer, cut it to size, and slide it into your Glass Touch GT12X for a customized look. For the custom-printed glass, export the layout and sent it over to your e:cue partner.

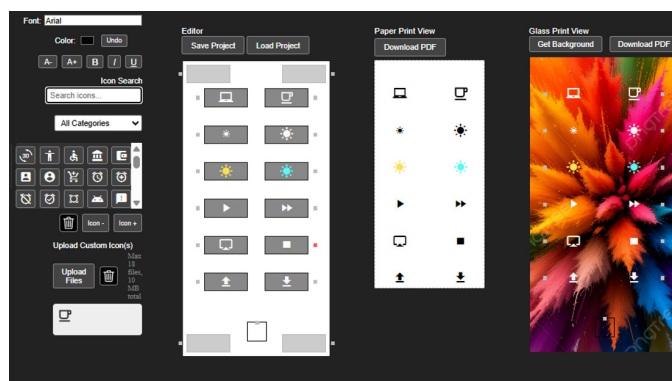
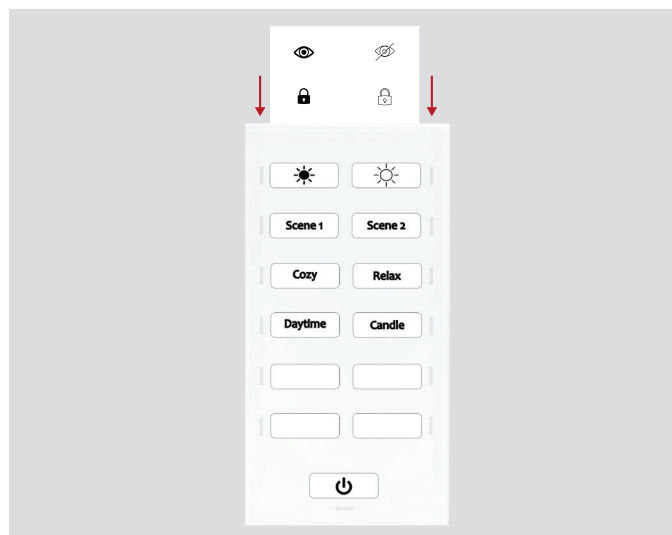
Glass Touch Designer:**Paper insert:**

System diagram

a) DALI-2 protocol

A) DALI-2 (2-wire cabling - up to 300m)

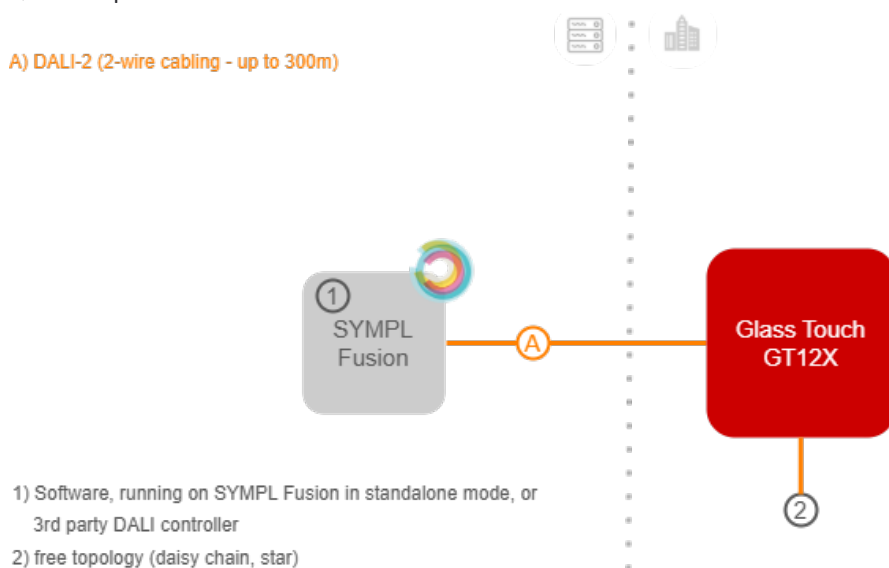

b) e:bus2 protocol

A) e:bus2 (2-wire cabling - tentative: up to 300m)

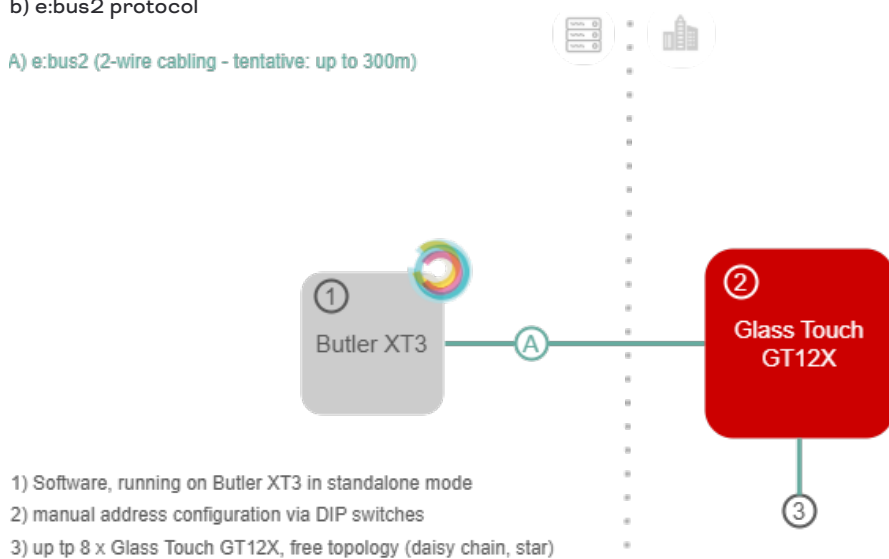

Dimensions

All measures in mm

