

DALI2 Panel 4-Key

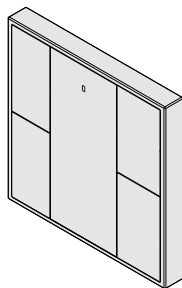

Highlights

- DALI-2 control device with 4 push buttons according to IEC62386-101, IEC62386-103, IEC62386-301 and IEC62386-332
- Available in three color versions: metal, black and white
- Suitable for integration and in combination with DALI-2 compliant central control units
- Supports feedback functionality, provides 8 LEDs
- Multimaster capable, multiple modules can be installed on the DALI line
- DALI bus powered, no extra power supply required
- Easy installation: the device can be installed in a flush-mounted installation box
- Compatible with universal 55mm frames

Delivery scope

Identcode

- e:cue DALI2 Panel 4-Key (main body, frame, mounting plate)
 - metal CL23100279055
 - white CL23100279255
 - black CL23100279455
- Screws, 2 x
- Transparent central cover plate
- Safety instructions
- Instructions

Optional accessories

- SYMPL dali Node AB444230035

Product specifications

Dimensions (W x H x D)	80 x 80 x 26.6 mm / 3.15 x 3.15 x 1.05 in
Weight	black, white: 89.5 g / 0.2 lb metal: 101.4 g / 0.22 lb
Mounting	Wall mount, suitable for most international in-wall mounted boxes
Max. casing temperature T _c	75 °C
Expected life time @T _c	50,000 H

e:cue Interfaces

Lighting applications are heterogeneous by nature. e:cue interfaces serve to integrate many networks, protocols and third party products into e:cue solutions. They also aid in applying special control functions for fixtures, they integrate analog or mechanical signaling into the digital world and offer bridging functions. e:cue interfaces are the links to bring together the many techniques and technologies of lighting control.

Protection class	II in Intended Use
Protection degree housing	IP20
Protection degree terminals	IP20
Certificates	CE, DALI-2, UKCA, RoHS

DALI interface

Input type	DALI
Marking	DA, DA
Voltage range	12 V DC - 22.5 V DC (according IEC62386-101)
Typ. current consumption DALI (at 16.5 V)	2 mA
Max. current consumption DALI (Inrush current at 22.5 V)	10 mA
Number of addresses for DALI control gear	DALI
Number of addresses for DALI control devices	4 programmable push buttons
Number of feedback LEDs	8 programmable LEDs
Push confirmation LED	yes (1)

Terminals

Connection type	Push-In
Wire size solid core	0.2 ... 1.5 mm ² (AWG 26 ... AWG 16)
Wire size fine core	0.2 ... 1.5 mm ² (AWG 26 ... AWG 16)
Wire size using wire end ferrule	0.25 ... 1.0 mm ²
Stripping length	9 ... 10 mm / 0.35 ... 0.39 inch
Tightening / release of wire	Push button

Environment conditions

Storing temperature	-20 ... +50 °C / -4 ... 122 °F
Working ambient temperature	-20 ... +50 °C / -4 ... 122 °F
Relative humidity	8 ... 80 %



DALI2 Panel 4-Key

Dimensions

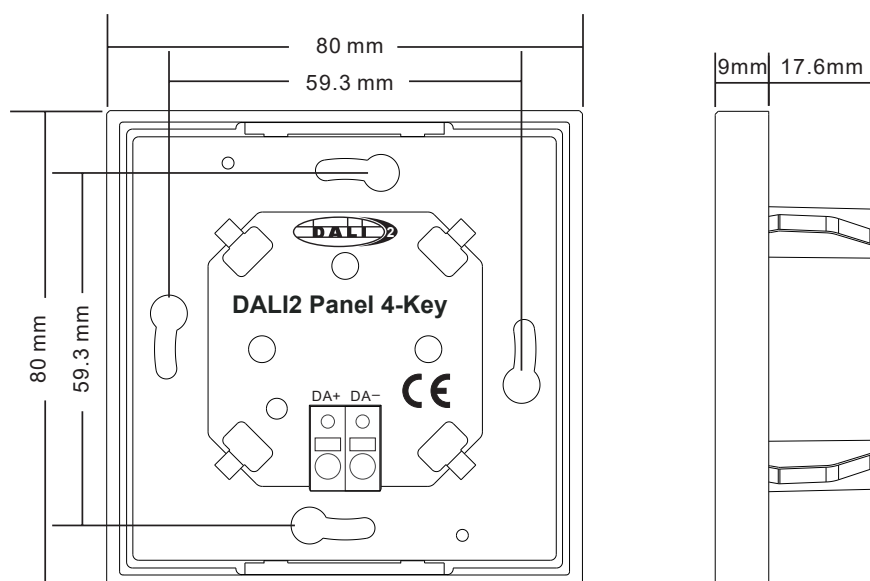

Application

Integration in a system with DALI-2 compliant central control unit, button pushes result in input notifications (event messages).

System diagram

A) e.net (ethernet based protocol)

B) DALI

